

## NUXY Monochromatic DATA-SHEET

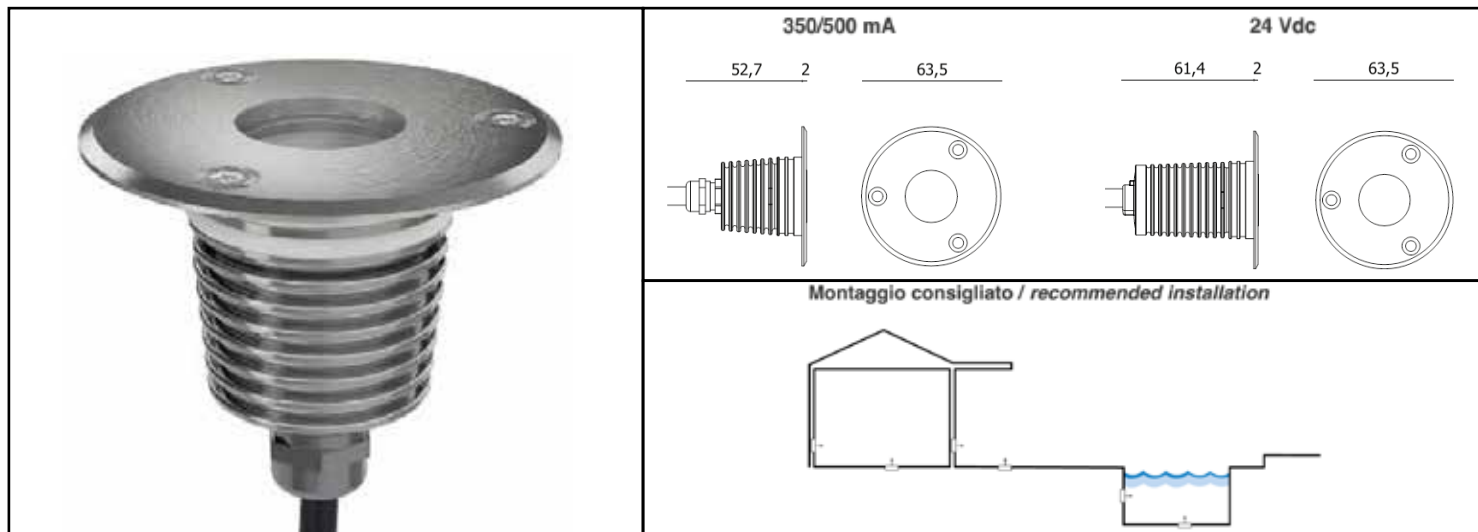

### PRODUCT DESCRIPTION:

Professional drive-over recessed fixture suitable for indoor, outdoor and underwater settings. Body stainless steel AISI 316L and tempered transparent or satin flat glass. All the materials are suitable for use in swimming pools, fountains and with salt water. UV resistance of all materials.

### TECHNICALS FEATURES:

<b>Materials</b>	Stainless steel AISI 316L ; tempered transparent or satin flat glass
<b>Front Finishes</b>	Satin stainless steel inox Aisi 316 L
<b>Power Supply</b>	350-500mA or 24 Vdc constant voltage
<b>Power</b>	1 W @350 mA - 1,5 W @500 mA - 2 W @24 Vdc
<b>Light Source</b>	Power LED LM 80 COMPLIANT
<b>Color Temperature</b>	2700 K ; 3000K ; 4000K
<b>Ra</b>	> 80
<b>Chromatic Selection</b>	Mac-Adam 2-step
<b>Lifetime</b>	> 50000 h (TM21 L80 B10 @50000h)
<b>Optics</b>	Honeycomb 8° ; narrow beam 9° ; medium beam 24° ; wide beam 43° ; transparent diffuser 111° ; satin diffuser 97°
<b>Tc metal body</b>	< 90 °C
<b>Ta operating temperature</b>	- 30 ÷ 50 °C
<b>Ts surface temperature</b>	≤ 65 °C
<b>Functions</b>	On/Off ; dimmable
<b>Cable</b>	<b>350/500 mA:</b> AWM style 20233 2xAWG18 (Red;Black) Ø 5,2 L. 0,5 m. <b>24 Vdc:</b> AWM style 20233 2xAWG18 (Red;Black)+1xAWG20 (Violet) Ø 6,2 L. 1m.
<b>Weigth</b>	260 g
<b>Installations</b>	Recessed (wall, floor)
<b>Norms</b>	60598-1 ; 60598-2 and its parts



### NOTE:

Power supplies, control&dimming devices and fixing kits must to be orderd separately. Aldabra power supply consumption is equal to 15% of the fixture nominal power. Photometric data available at [www.aldabra.it](http://www.aldabra.it)

## NUXY Monochromatic DATA-SHEET

### GENERAL FEATURES:

	power(W) @350 mA	power(W) @500 mA	power(W) @24 Vdc
<b>NUX.01.XXXXX.X</b>	1	1,5	
<b>NUX.02.XXXXX.X</b>			2

### OPTICAL FEATURES:

<b>NUX.XX.HXXXX.X</b>	Honeycomb 8°
<b>NUX.XX.MXXXX.X</b>	Narrow beam 9°
<b>NUX.XX.FXXXX.X</b>	Medium beam 24°
<b>NUX.XX.WXXXX.X</b>	Wide beam 43°
<b>NUX.XX.TXXXX.X</b>	Transparent diffuser 111°
<b>NUX.XX.SXXXX.X</b>	Satin diffuser 97°

### LED FEATURES:

	Power LED	lm/W	Ra	Chromatic selection
<b>NUX.XX.X27XX.X</b>	2700K warm white	105	>80	MacAdam 2-step
<b>NUX.XX.X30XX.X</b>	3000K warm white	118	>80	MacAdam 2-step
<b>NUX.XX.X40XX.X</b>	4000K neutral white	130	>80	MacAdam 2-step

### FINISHES FEATURES:

<b>NUX.XX.XXXS1.X</b>	Satin stainless steel
-----------------------	-----------------------

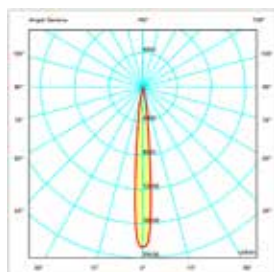

narrow beam 9°

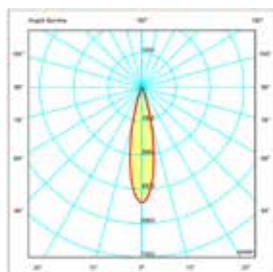

medium beam 24°

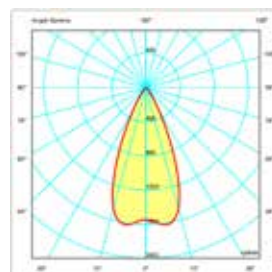

wide beam 43°

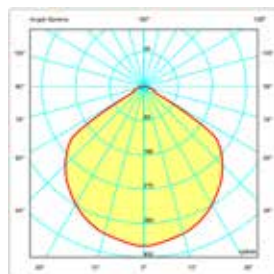

transparent diffuser 111°

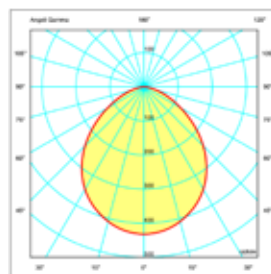

satin diffuser 97°

### GENERAL INFORMATIONS:

Kindly note that atmospheric agents ( such as lightnings, etc ) , electrostatics charges or disturbances on the installation not caused by Aldabra lighting fixtures and Led drivers indicated by Aldabra itself, may cause damages on the fixtures. It is necessary that the electrical installation where the LED lighting fittings and their power supply units and control gears are installed must be equipped with proper devices for the protection and suppression of transient phenomena (SPD, isolation transformer, etc...). Such devices must be coordinated with the other protections of the installation; on this theme, it's necessary to refer to the electrical installations norms which are in force in each country.

## NUXY Monochromatic DATA-SHEET

### RECESSING BOXES:

#### CSF.0009.0

draining recessing box

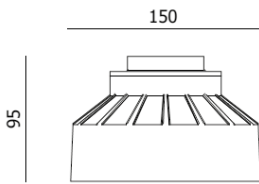

#### CSF.0010.0

recessing box h. 95 mm

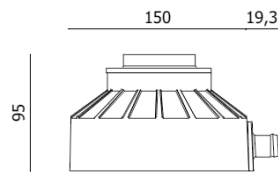

#### CSF.0011.0

recessing box for IP68  
h. 168 mm

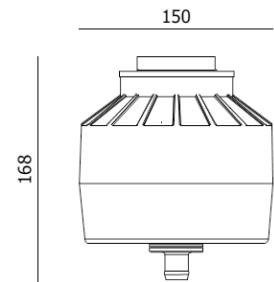

### ACCESSORIES:

#### ACC.0268.0

PG closing tool for IP68 recessing box

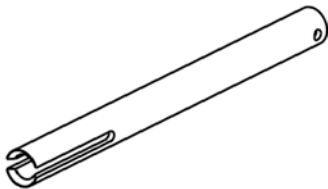

## NUXY RGB DATA-SHEET

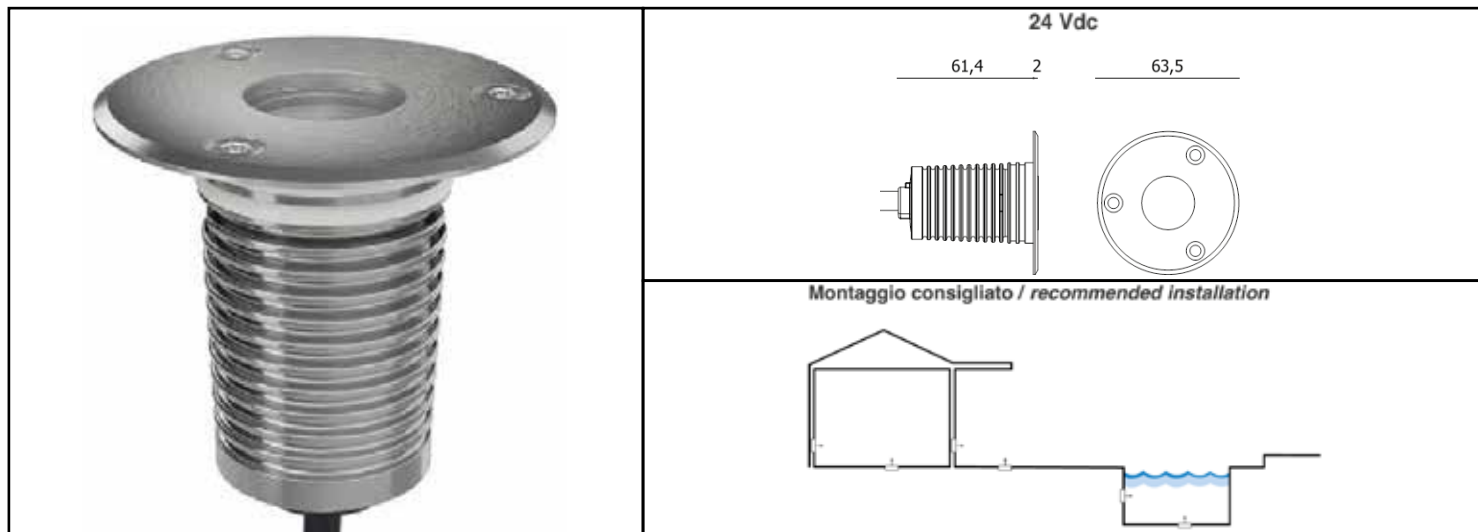

### PRODUCT DESCRIPTION:

Professional drive-over recessed fixture suitable for indoor, outdoor and underwater settings. Body stainless steel AISI 316L and tempered transparent or satin flat glass. All the materials are suitable for use in swimming pools, fountains and with salt water. UV resistance of all materials.

### TECHNICALS FEATURES:

<b>Materials</b>	Stainless steel AISI 316L ; tempered transparent or satin flat glass
<b>Front Finishes</b>	Satin stainless steel inox Aisi 316 L
<b>Power Supply</b>	24 Vdc constant voltage
<b>Power</b>	4W
<b>Light Source</b>	Power LED LM 80 COMPLIANT
<b>Dominant Wavelength</b>	R=622nm, G=530nm, B=470nm
<b>Lifetime</b>	> 50000 h (TM21 L80 B10 @50000h)
<b>Optics</b>	Wide beam 45° ; transparent diffuser 111° ; satin diffuser 97°
<b>Tc metal body</b>	< 90 °C
<b>Ta operating temperature</b>	- 30 ÷ 50 °C
<b>Ts surface temperature</b>	≤ 65 °C
<b>Functions</b>	On/Off ; dimmable
<b>Cable</b>	AWM style 20233 2xAWG18 (Red;Black)+3xAWG20 (R/N, G/N, B/N) L. 1m.
<b>Weigth</b>	260 g
<b>Installations</b>	Recesed (wall, floor)
<b>Norms</b>	60598-1 ; 60598-2 and its parts



### NOTE:

Power supplies, control&dimming devices and fixing kits must to be orderd separately. Aldabra power supply consumption is equal to 15% of the fixture nominal power. Photometric data available at [www.aldabra.it](http://www.aldabra.it)

## NUXY RGB DATA-SHEET

### GENERAL FEATURES:

	power
<b>NUX.02.XXXXX.X</b>	4W

### OPTICAL FEATURES:

<b>NUX.XX.WXXXX.X</b>	Wide beam 45°
<b>NUX.XX.TXXXX.X</b>	Transparent diffuser 111°
<b>NUX.XX.SXXXX.X</b>	Satin diffuser 97°

### LED FEATURES:

	Power LED
<b>NUX.XX.X90XX.X</b>	R, G, B

### FINISHES FEATURES:

<b>NUX.XX.XXXS1.X</b>	Satin stainless steel
-----------------------	-----------------------

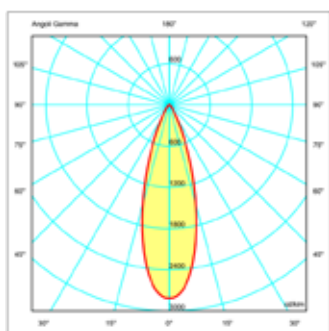

wide beam 45°

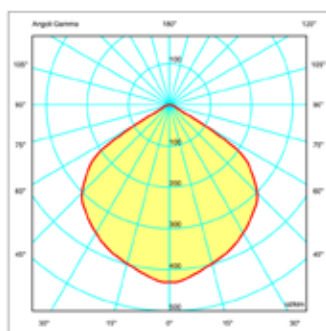

transparent diffuser 111°

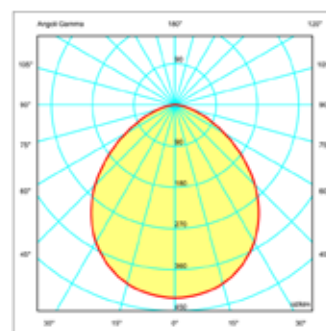

satin diffuser 97°

### GENERAL INFORMATIONS:

Kindly note that atmospheric agents ( such as lightnings, etc ) , electrostatics charges or disturbances on the installation not caused by Aldabra lighting fixtures and Led drivers indicated by Aldabra itself, may cause damages on the fixtures. It is necessary that the electrical installation where the LED lighting fittings and their power supply units and control gears are installed must be equipped with proper devices for the protection and suppression of transient phenomena (SPD, isolation transformer, etc...). Such devices must be coordinated with the other protections of the installation; on this theme, it's necessary to refer to the electrical installations norms which are in force in each country.

## NUXY RGB DATA-SHEET

### RECESSING BOXES:

#### CSF.0009.0

draining recessing box

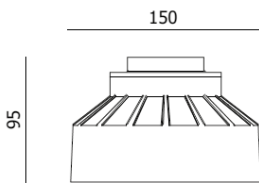

#### CSF.0010.0

recessing box h. 95 mm

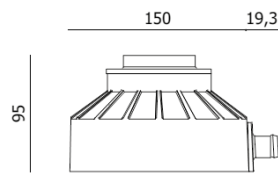

#### CSF.0011.0

recessing box for IP68  
h. 168 mm

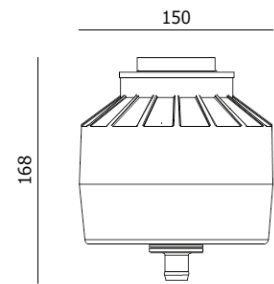

#### ACC.0268.0

PG closing tool for IP68 recessing box

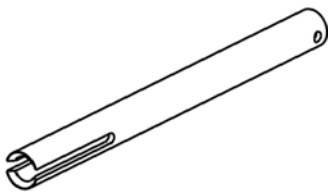

Product code	Code	Release date	Product	Power	Supply	CCT	Optics	lux (lm) *tj=25 **	Fixture Flux (lm)
NUX.02.H27S1.0	NUX.02.H27S1.0	8/5	Nuxy	2W	24V	2700 K	Honeycomb	153,75**	105,27
NUX.02.H30S1.0	NUX.02.H30S1.0	8/5	Nuxy	2W	24V	3000 K	Honeycomb	161,25**	107,97
NUX.02.H40S1.0	NUX.02.H40S1.0	8/5	Nuxy	2W	24V	4000 K	Honeycomb	176,25**	112,07
NUX.01.F27S1.0	NUX.01.F27S1.0 350mA	8/5	Nuxy	1W	350 mA	2700 K	Lens 24°	114,80**	94,80
NUX.01.F27S1.0	NUX.01.F27S1.0 500mA	8/5	Nuxy	1,5W	500 mA	2700 K	Lens 24°	153,75**	130,29
NUX.01.F30S1.0	NUX.01.F30S1.0 350mA	8/5	Nuxy	1W	350 mA	3000 K	Lens 24°	120,40**	97,24
NUX.01.F30S1.0	NUX.01.F30S1.0 500mA	8/5	Nuxy	1,5W	500 mA	3000 K	Lens 24°	161,25**	133,64
NUX.01.F40S1.0	NUX.01.F40S1.0 350mA	8/5	Nuxy	1W	350 mA	4000 K	Lens 24°	131,60**	100,93
NUX.01.F40S1.0	NUX.01.F40S1.0 500mA	8/5	Nuxy	1,5W	500 mA	4000 K	Lens 24°	176,25**	138,71
NUX.02.F27S1.0	NUX.02.F27S1.0	8/5	Nuxy	2W	24V	2700 K	Lens 24°	153,75**	130,29
NUX.02.F30S1.0	NUX.02.F30S1.0	8/5	Nuxy	2W	24V	3000 K	Lens 24°	161,25**	133,64
NUX.02.F40S1.0	NUX.02.F40S1.0	8/5	Nuxy	2W	24V	4000 K	Lens 24°	176,25**	138,71
NUX.01.W27S1.0	NUX.01.W27S1.0 350mA	8/5	Nuxy	1W	350 mA	2700 K	Lens 43°	114,80**	95,72
NUX.01.W27S1.0	NUX.01.W27S1.0 500mA	8/5	Nuxy	1,5W	500 mA	2700 K	Lens 43°	153,75**	131,56
NUX.01.W30S1.0	NUX.01.W30S1.0 350mA	8/5	Nuxy	1W	350 mA	3000 K	Lens 43°	120,40**	98,19
NUX.01.W30S1.0	NUX.01.W30S1.0 500mA	8/5	Nuxy	1,5W	500 mA	3000 K	Lens 43°	161,25**	134,95
NUX.01.W40S1.0	NUX.01.W40S1.0 350mA	8/5	Nuxy	1W	350 mA	4000 K	Lens 43°	131,60**	101,91
NUX.01.W40S1.0	NUX.01.W40S1.0 500mA	8/5	Nuxy	1,5W	500 mA	4000 K	Lens 43°	176,25**	140,07
NUX.02.W27S1.0	NUX.02.W27S1.0	8/5	Nuxy	2W	24V	2700 K	Lens 43°	153,75**	131,56
NUX.02.W30S1.0	NUX.02.W30S1.0	8/5	Nuxy	2W	24V	3000 K	Lens 43°	161,25**	134,95
NUX.02.W40S1.0	NUX.02.W40S1.0	8/5	Nuxy	2W	24V	4000 K	Lens 43°	176,25**	140,07
NUX.02.W90S1.0	NUX.02.W90S1.0	8/5	Nuxy	4W	24V	RGB	Lens 45°	105,00*	53,19
NUX.02.W90S1.0	NUX.02.W90S1.0 R	8/5	Nuxy	1W	24V	RGB (Rosso)	Lens 45°	35,00*	19,04
NUX.02.W90S1.0	NUX.02.W90S1.0 G	8/5	Nuxy	1W	24V	RGB (Verde)	Lens 45°	57,00*	39,08
NUX.02.W90S1.0	NUX.02.W90S1.0 B	8/5	Nuxy	1W	24V	RGB (Blu)	Lens 45°	13,00*	7,17
NUX.01.M27S1.0	NUX.01.M27S1.0 350mA	8/5	Nuxy	1W	350 mA	2700 K	Lens 9°	114,80**	99,09
NUX.01.M27S1.0	NUX.01.M27S1.0 500mA	8/5	Nuxy	1,5W	500 mA	2700 K	Lens 9°	153,75**	136,19
NUX.01.M30S1.0	NUX.01.M30S1.0 350mA	8/5	Nuxy	1W	350 mA	3000 K	Lens 9°	120,40**	101,64
NUX.01.M30S1.0	NUX.01.M30S1.0 500mA	8/5	Nuxy	1,5W	500 mA	3000 K	Lens 9°	161,25**	139,69
NUX.01.M40S1.0	NUX.01.M40S1.0 350mA	8/5	Nuxy	1W	350 mA	4000 K	Lens 9°	131,60**	105,49
NUX.01.M40S1.0	NUX.01.M40S1.0 500mA	8/5	Nuxy	1,5W	500 mA	4000 K	Lens 9°	176,25**	144,99
NUX.02.M27S1.0	NUX.02.M27S1.0	8/5	Nuxy	2W	24V	2700 K	Lens 9°	153,75**	136,19
NUX.02.M30S1.0	NUX.02.M30S1.0	8/5	Nuxy	2W	24V	3000 K	Lens 9°	161,25**	139,69
NUX.02.M40S1.0	NUX.02.M40S1.0	8/5	Nuxy	2W	24V	4000 K	Lens 9°	176,25**	144,99
NUX.01.S27S1.0	NUX.01.S27S1.0 350mA	8/5	Nuxy	1W	350 mA	2700 K	Satin Glass	114,80**	72,20
NUX.01.S27S1.0	NUX.01.S27S1.0 500mA	8/5	Nuxy	1,5W	500 mA	2700 K	Satin Glass	153,75**	99,23
NUX.01.S30S1.0	NUX.01.S30S1.0 350mA	8/5	Nuxy	1W	350 mA	3000 K	Satin Glass	120,40**	74,09
NUX.01.S30S1.0	NUX.01.S30S1.0 500mA	8/5	Nuxy	1,5W	500 mA	3000 K	Satin Glass	161,25**	101,83
NUX.01.S40S1.0	NUX.01.S40S1.0 350mA	8/5	Nuxy	1W	350 mA	4000 K	Satin Glass	131,60**	76,95
NUX.01.S40S1.0	NUX.01.S40S1.0 500mA	8/5	Nuxy	1,5W	500 mA	4000 K	Satin Glass	176,25**	105,76
NUX.02.S27S1.0	NUX.02.S27S1.0	8/5	Nuxy	2W	24V	2700 K	Satin Glass	153,75**	99,23
NUX.02.S30S1.0	NUX.02.S30S1.0	8/5	Nuxy	2W	24V	3000 K	Satin Glass	161,25**	101,83
NUX.02.S40S1.0	NUX.02.S40S1.0	8/5	Nuxy	2W	24V	4000 K	Satin Glass	176,25**	105,76
NUX.02.S90S1.0	NUX.02.S90S1.0	8/5	Nuxy	4W	24V	RGB	Satin Glass	105,00*	44,71
NUX.02.S90S1.0	NUX.02.S90S1.0 R	8/5	Nuxy	1W	24V	RGB (Rosso)	Satin Glass	35,00*	15,34
NUX.02.S90S1.0	NUX.02.S90S1.0 G	8/5	Nuxy	1W	24V	RGB (Verde)	Satin Glass	57,00*	31,49
NUX.02.S90S1.0	NUX.02.S90S1.0 B	8/5	Nuxy	1W	24V	RGB (Blu)	Satin Glass	13,00*	5,78
NUX.01.T27S1.0	NUX.01.T27S1.0 350mA	8/5	Nuxy	1W	350 mA	2700 K	Trasparent Glass	114,80**	85,03
NUX.01.T27S1.0	NUX.01.T27S1.0 500mA	8/5	Nuxy	1,5W	500 mA	2700 K	Trasparent Glass	153,75**	116,87
NUX.01.T30S1.0	NUX.01.T30S1.0 350mA	8/5	Nuxy	1W	350 mA	3000 K	Trasparent Glass	120,40**	87,26
NUX.01.T30S1.0	NUX.01.T30S1.0 500mA	8/5	Nuxy	1,5W	500 mA	3000 K	Trasparent Glass	161,25**	119,93
NUX.01.T40S1.0	NUX.01.T40S1.0 350mA	8/5	Nuxy	1W	350 mA	4000 K	Trasparent Glass	131,60**	90,63
NUX.01.T40S1.0	NUX.01.T40S1.0 500mA	8/5	Nuxy	1,5W	500 mA	4000 K	Trasparent Glass	176,25**	124,56
NUX.02.T27S1.0	NUX.02.T27S1.0	8/5	Nuxy	2W	24V	2700 K	Trasparent Glass	153,75**	116,87
NUX.02.T30S1.0	NUX.02.T30S1.0	8/5	Nuxy	2W	24V	3000 K	Trasparent Glass	161,25**	119,93
NUX.02.T40S1.0	NUX.02.T40S1.0	8/5	Nuxy	2W	24V	4000 K	Trasparent Glass	176,25**	124,56
NUX.02.T90S1.0	NUX.02.T90S1.0	8/5	Nuxy	4W	24V	RGB	Trasparent Glass	105,00*	53,48
NUX.02.T90S1.0	NUX.02.T90S1.0 R	8/5	Nuxy	1W	24V	RGB (Rosso)	Trasparent Glass	35,00*	19,58
NUX.02.T90S1.0	NUX.02.T90S1.0 G	8/5	Nuxy	1W	24V	RGB (Verde)	Trasparent Glass	57,00*	40,19
NUX.02.T90S1.0	NUX.02.T90S1.0 B	8/5	Nuxy	1W	24V	RGB (Blu)	Trasparent Glass	13,00*	7,37